



ZALENINFORMATIE 2021

ZAAL	AFMETING	OPP	MAX PERS.	MAX PERS. CORONAPROOF		
				theateropstelling	examenopstelling	carré
Beneluxtheater	15.10 x 19.80 x h 5.75m	258 m2	325 / 650	98 stoelen per 2	75 looppaden	62 zitjes
Podium	12.60 x 9.30 h 4.60m	117 m2	80			
Kleedkamer	6.00 x 3.50m	21 m2	8			
Muziekzaal	12.50 x 11.50m	139 m2	110	39	21	20-26
Recreatiezaal	10.80 x 13.60m	146 m2	115	42	25	20-26
Zaal 1	8.10 x 6.90m	54 m2	35	16	12	10
Zaal 2	6.50 x 3.40m	22 m2	10	5		5
Zaal 3	10.80 x 6.50m	68 m2	50	8 vaste bureau-opstelling + 4 in blok		
Zaal 5	10.80 x 7.20m	77 m2	60	24		15-21
Zaal 6/7	7.20 x 5.10m	37 m2	30	11		8
Zaal 8	10.20 x 7.20m	78 m2	60	22		16
Zaal 9 (bieb)	10 x 15 m	150 m2	130	45 zitjes		
Zaal 10	5 x 8m + 2 X 1.5m	43 m2	25	7		7

ZAAL	SOC. TARIEF	COMM. TARIEF
Beneluxtheater	€ 92.50	€ 350.00
Podium		
Kleedkamer	€ 18.00	€ 40.00
Muziekzaal	€ 35.00	€ 130.00
Recreatiezaal	€ 39.00	€ 133.00
Zaal 1	€ 29.00	€ 70.00
Zaal 2	€ 20.00	€ 42.00
Zaal 3	€ 31.00	€ 80.00
Zaal 5	€ 33.00	€ 80.00
Zaal 6/7	€ 24.00	€ 63.00
Zaal 8	€ 37.00	€ 80.00
Zaal 9 (bieb)	€ 38.50	€ 125.50
Zaal 10	€ 26.50	€ 70.00

NB. Er zijn boven maximaal 20 grote tafels (160 x 80 cm) en 6 kleine tafels (120x 80 cm) beschikbaar (excl. tafels van zaal 1).

BENELUXTHEATER, afm. 15.10m x 19.80m

STOELINDELING met inachtneming van 1,5m. afstand: maximaal 98 stoelen

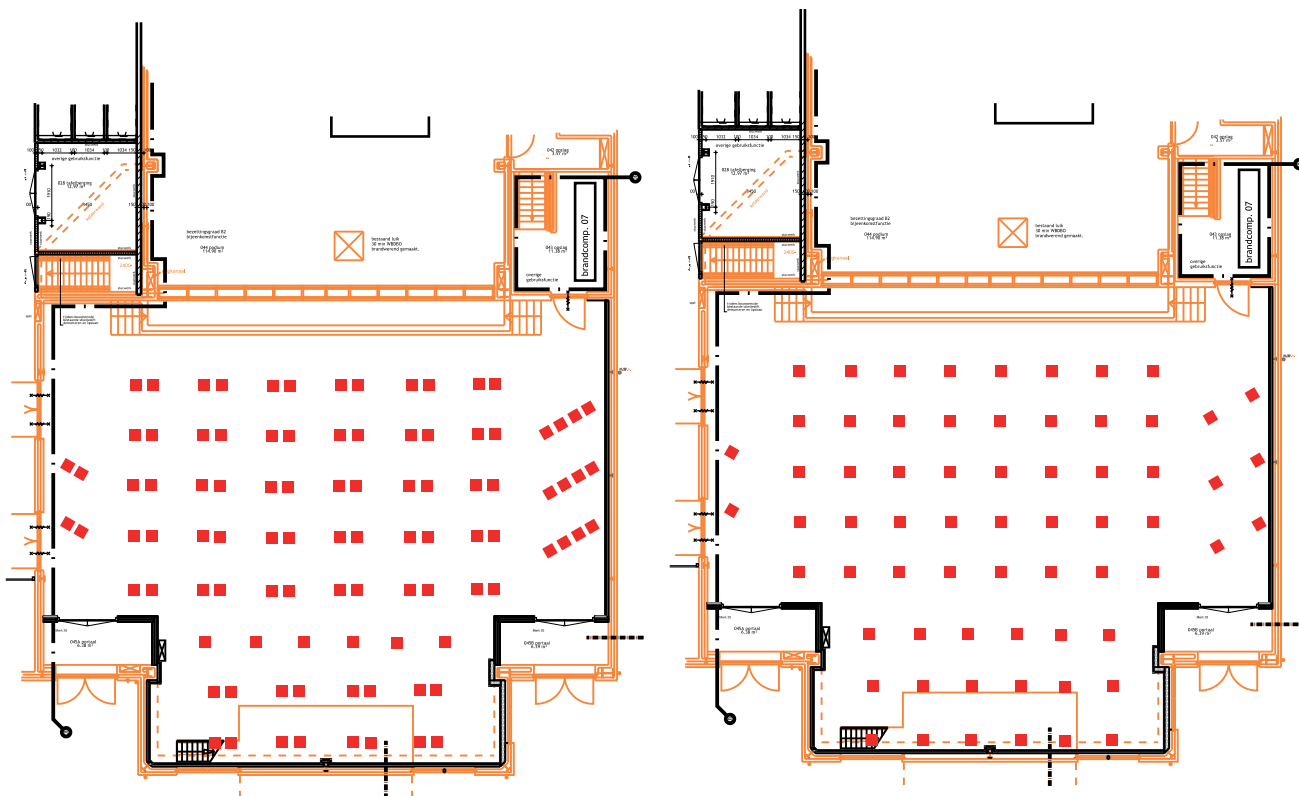



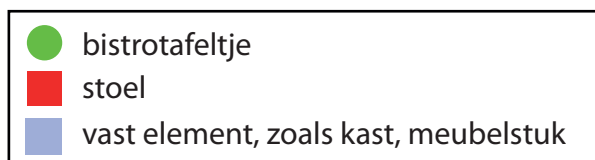
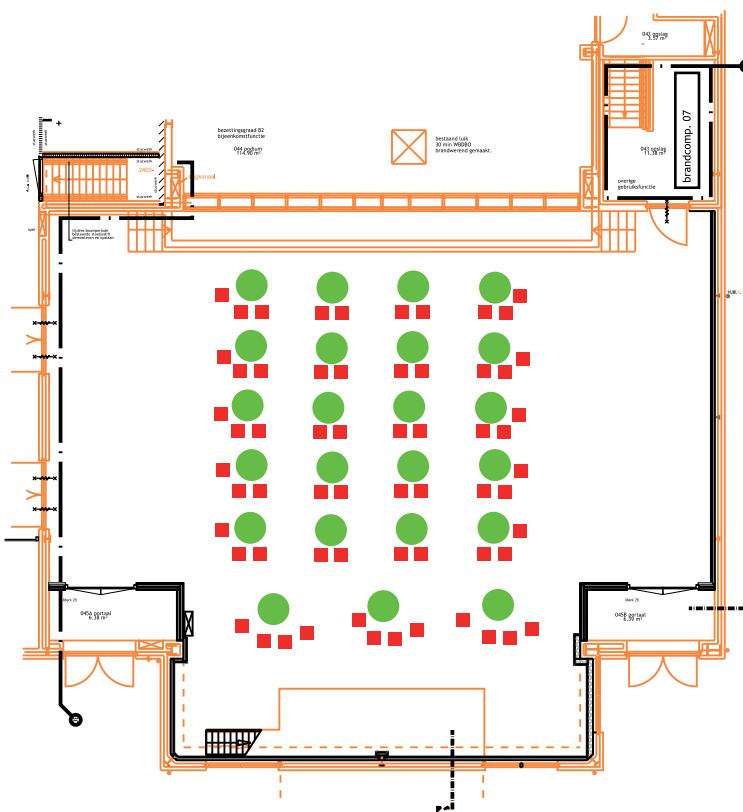

Theateropstelling: maximaal 98 stoelen;
losse opstelling: max. 65 stoelen
met gangpaden: max. 53 stoelen
Filmopstelling: 62 stoelen

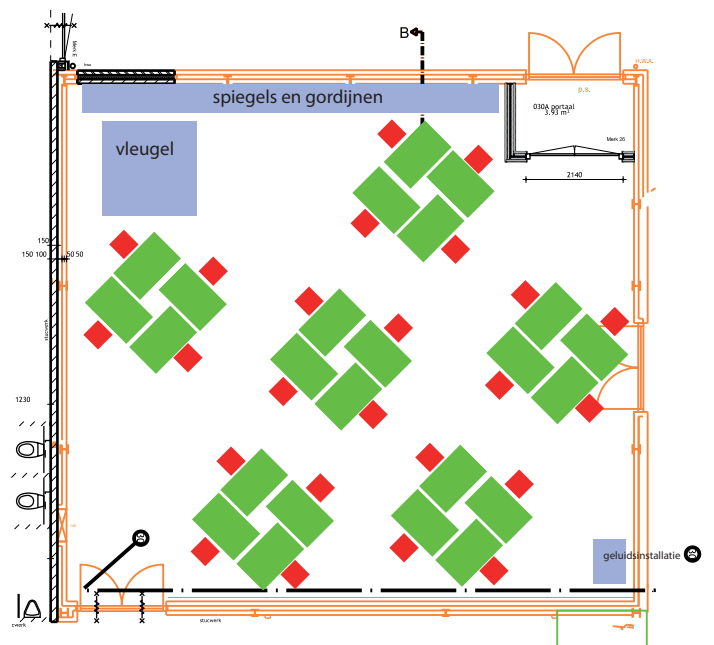
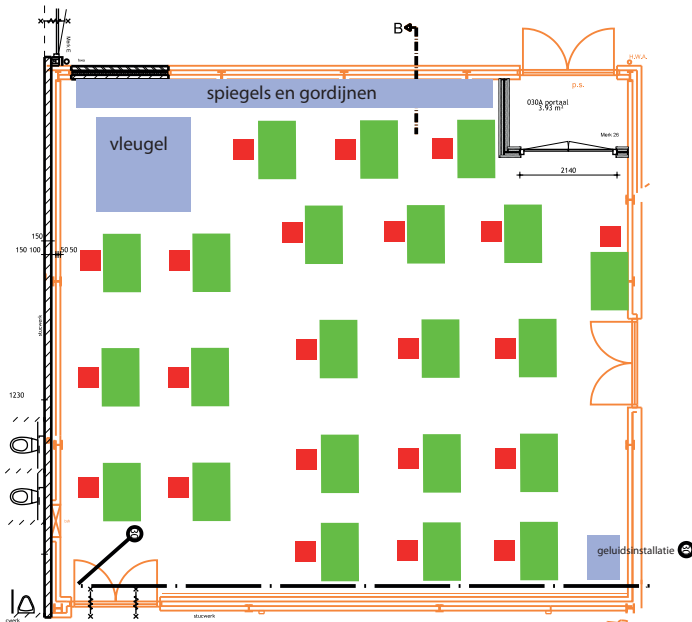
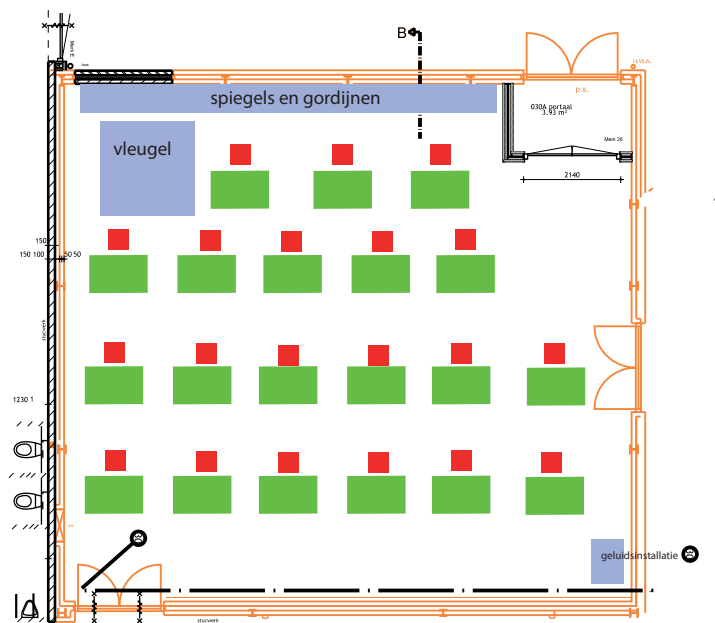
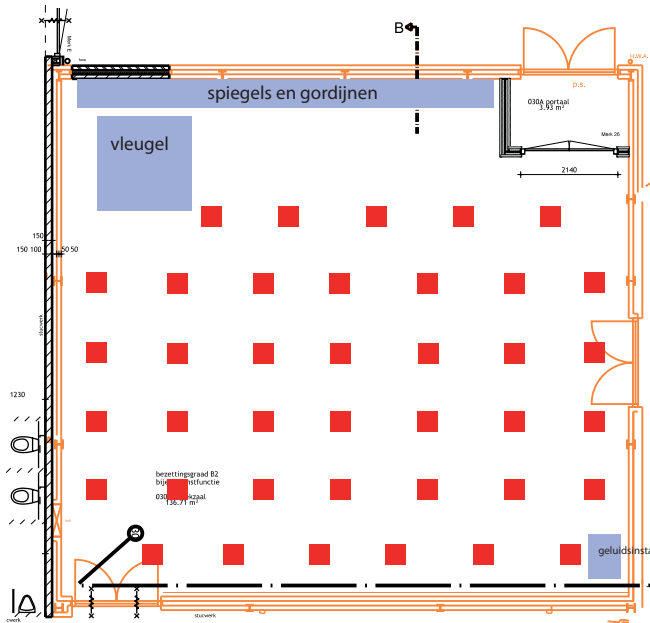

MUZIEKZAAL, afm. 12,50m. x 11,50m.

STOELINDELING met inachtneming van 1,5m. afstand: maximaal 39 stoelen



	tafel 1.40m x 0.80m
	stoel
	vast element, zoals kast, meubelstuk

Examenopstelling: 20 stoelen
Zitjes: 24 stoelen

RECREATIEZAAL, afm. 10.80m x 13.60m

STOELINDELING met inachtneming van 1,5m. afstand: maximaal 40 stoelen

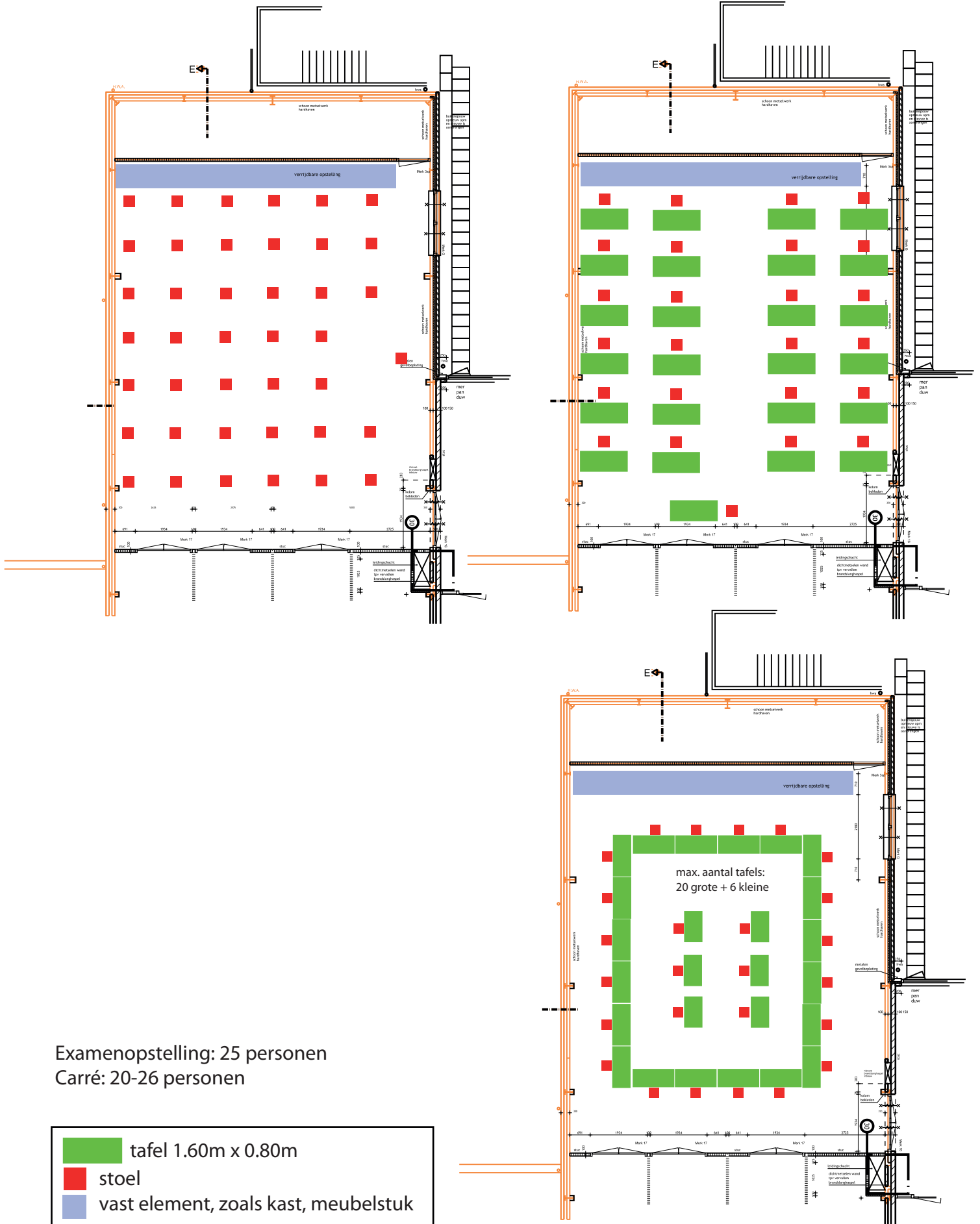

ZAAL 1, afm. 8.10m x 6.90m

STOELINDELING met inachtneming van 1,5m. afstand: maximaal 16 stoelen

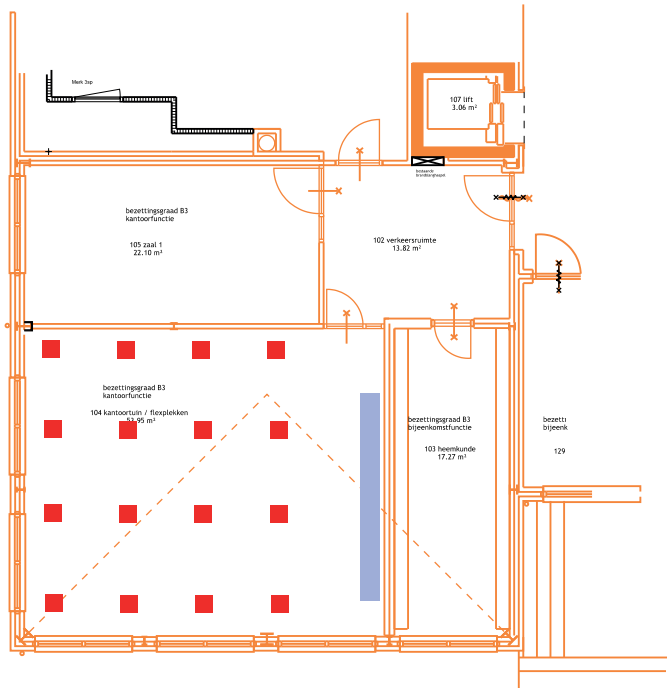

Carré: 10 personen

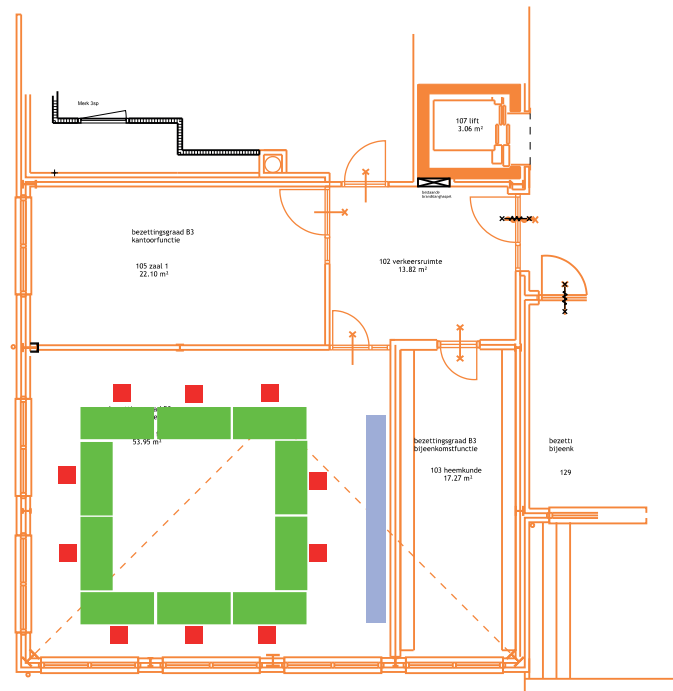

Examenopstelling: 12 personen

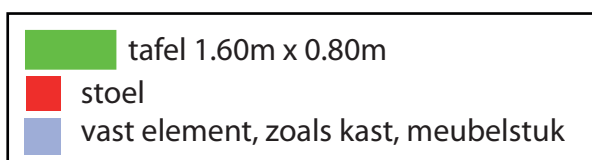
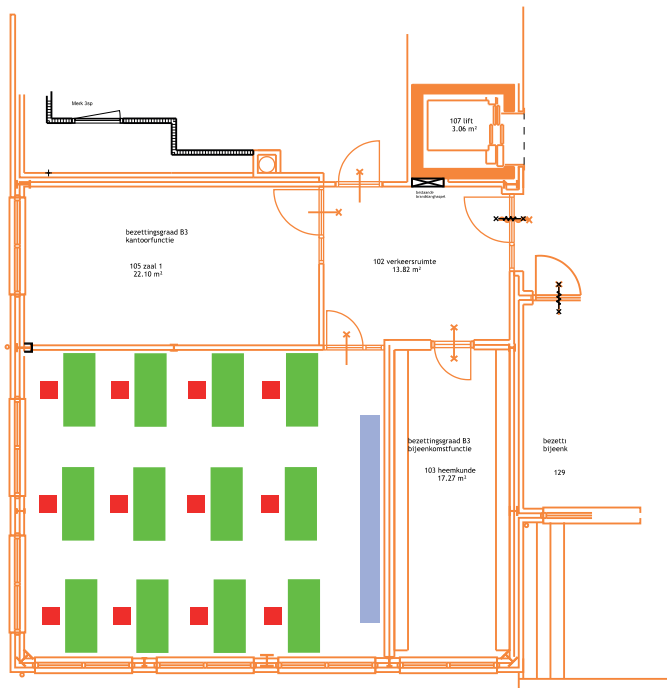

ZAAL 5, afm. 10.8m x 7.20m

STOELINDELING met inachtneming van 1,5m. afstand: maximaal 24 stoelen

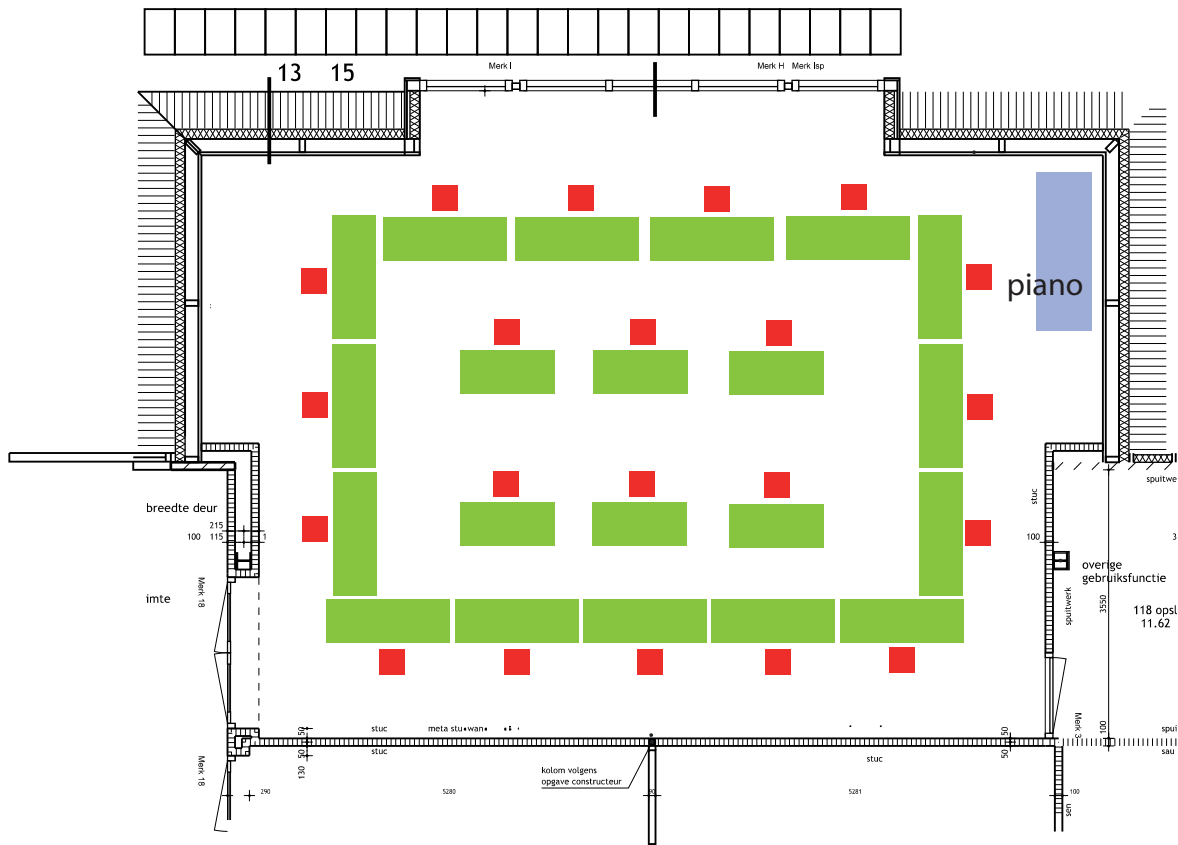
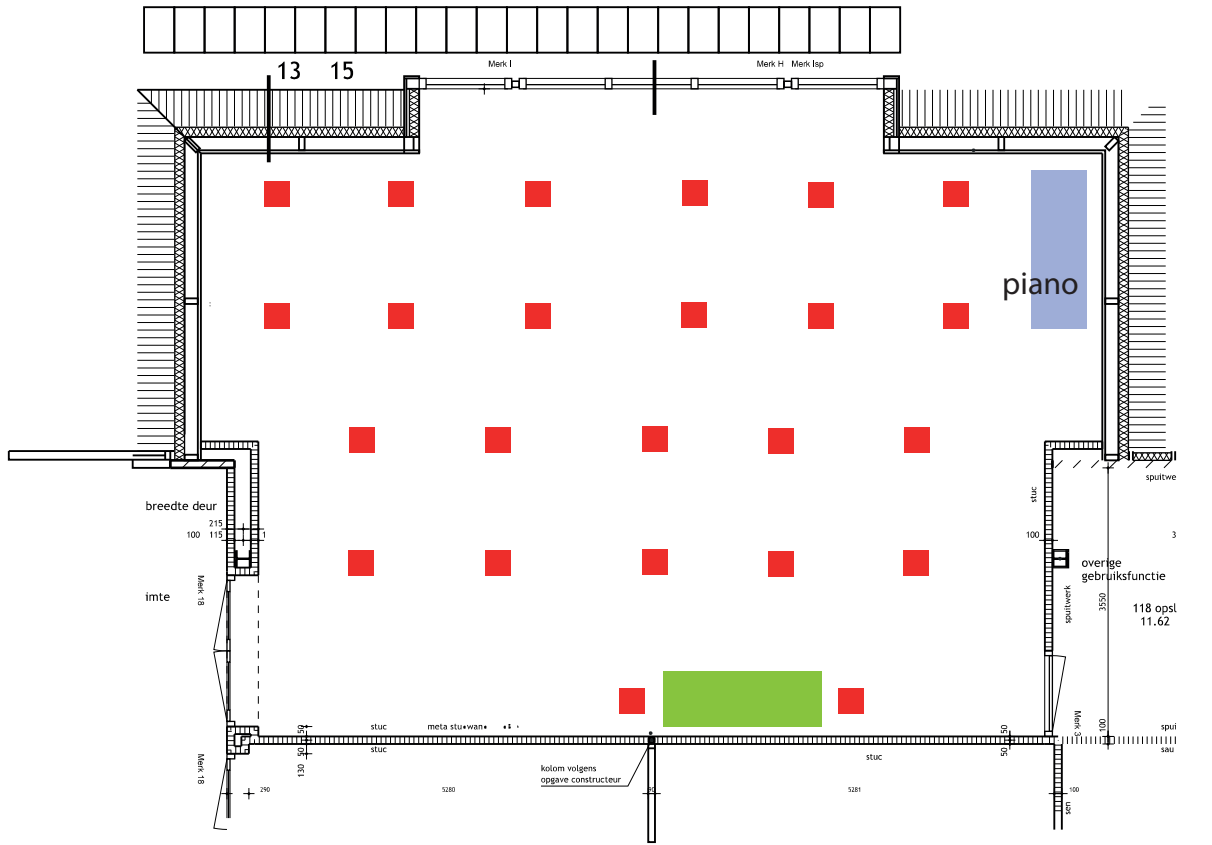





- tafel 1.60m x 0.80m
- stoel
- vast element, zoals kast, meubelstuk

Carré: 15-21 personen

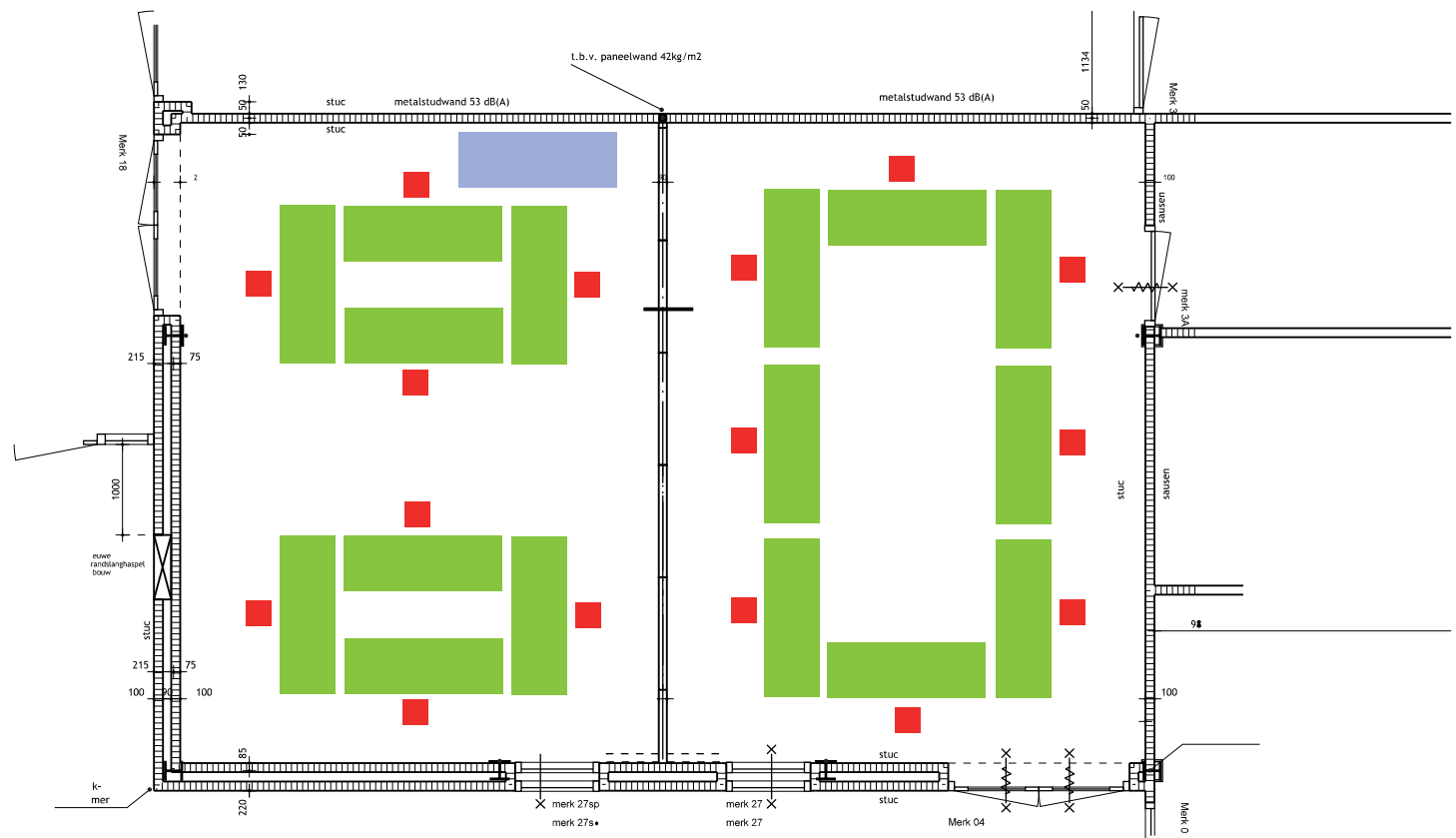
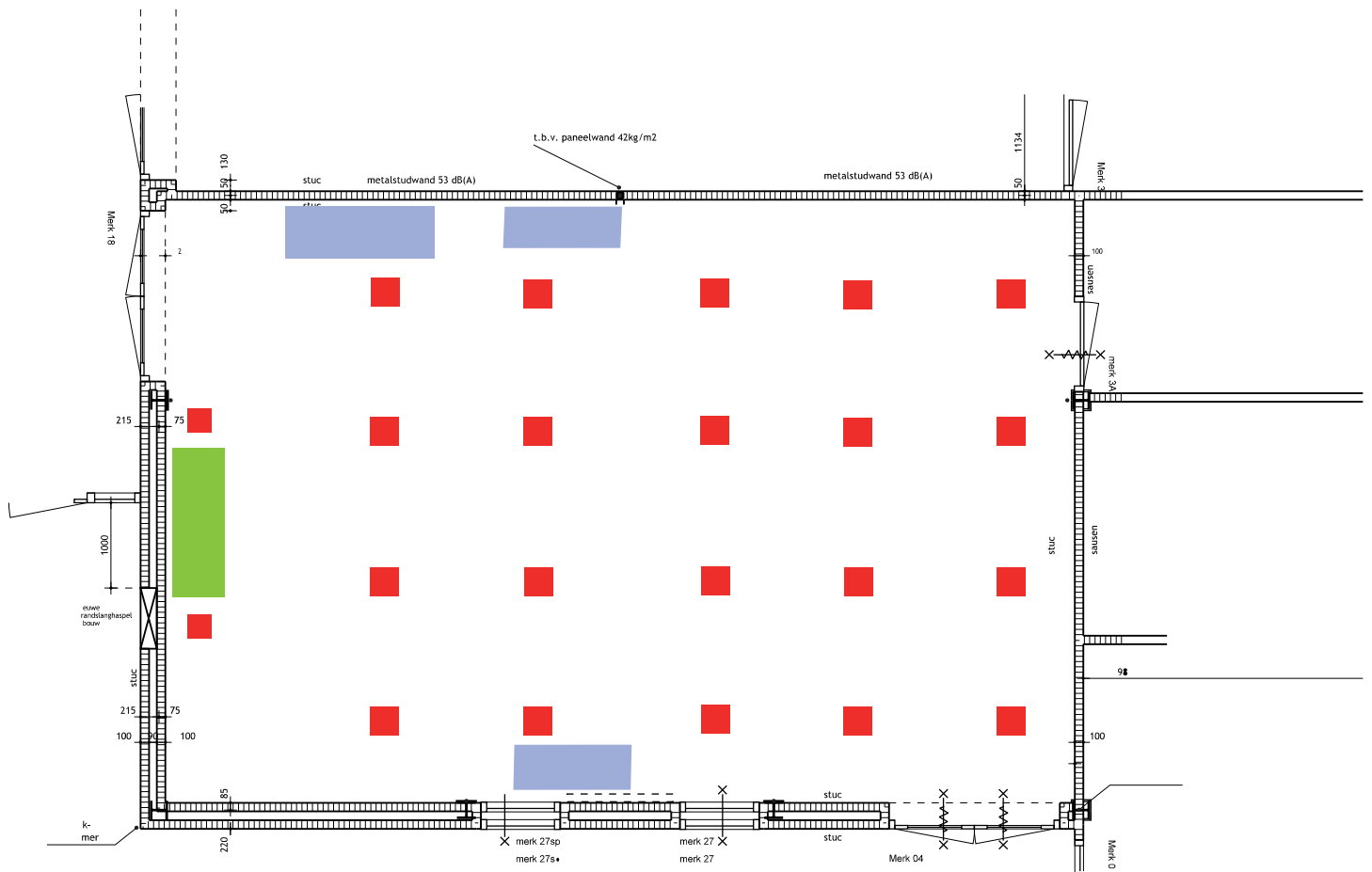
ZAAL 6 en 7 , afm. 10.20 m x 7.20m samen

STOELINDELING met inachtneming van 1,5m. afstand: maximaal 22 stoelen







	tafel 1.60m x 0.80m
	stoel
	vast element, zoals kast, meubelstuk

Carré: 8 personen per zaal

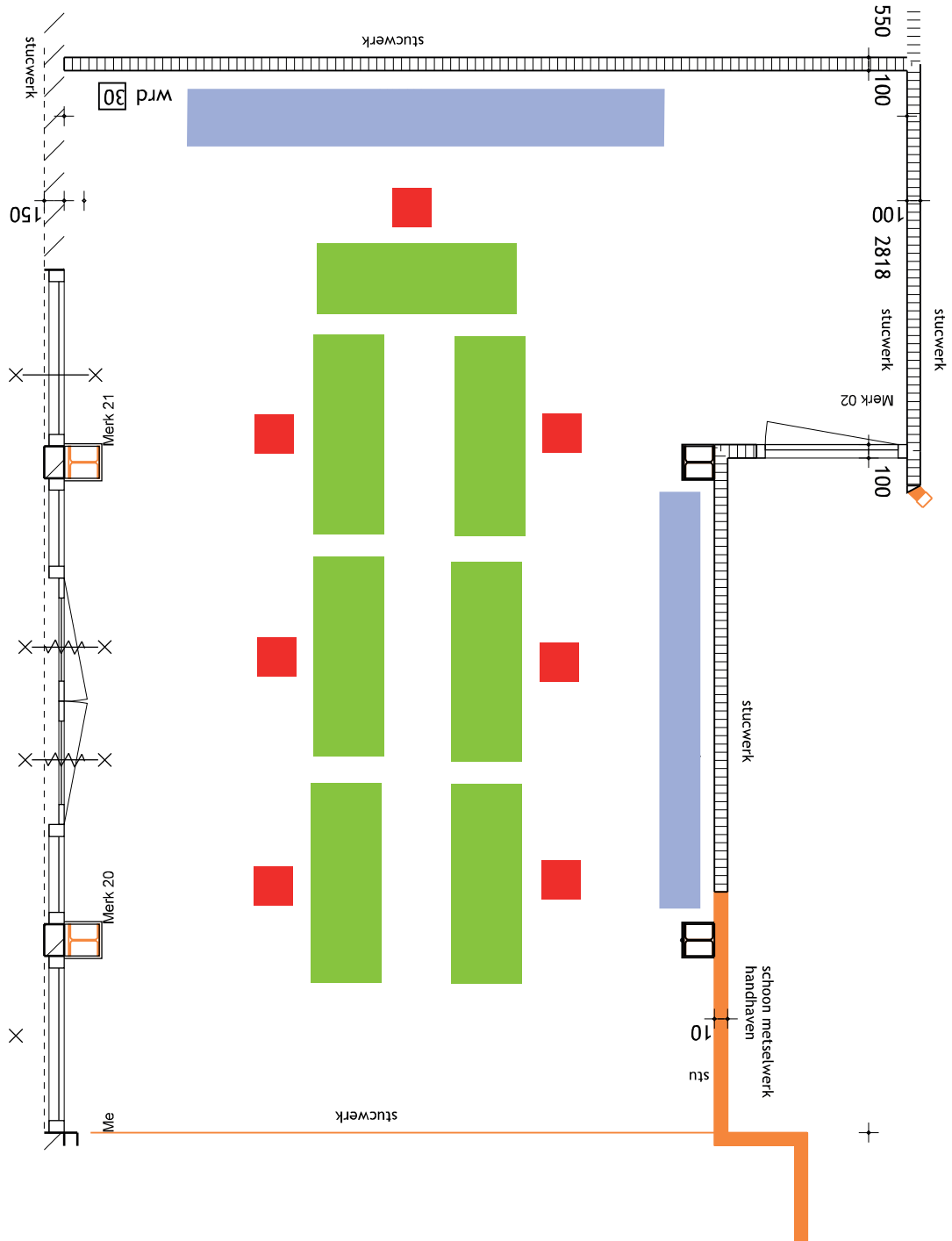
ZAAL 10 , afm. 5m x 8m + 2x 1,5m

STOELINDELING met inachtneming van 1,5m. afstand: maximaal 7 stoelen



-  tafel 1.60m x 0.80m
-  stoel
-  vast element, zoals kast, meubelstuk

Carré: 7 personen